



# *HISTORY OF ISLAMIC ARCHITECTURE IN EGYPT*

*FORM ARCHITECTURAL OF  
MOSQUES IN THE ISLAMIC  
ARCHITECTURE*

*DR/ KAMAL MAHMOUD  
ELGABALAWY*

*KAMAL\_ELGABALAWY@YAHOO.COM*

**THE REFERENCES TO MULTIPLE SOURCES ARE TEXT & FIGURES  
(SKETCHES, DRAWINGS, PICTURES, PHOTOS,...ETC.)**

**ALL THE RIGHTS BELONG TO ORIGINAL AUTHORS**

# History of Architecture

## 1-Rashidun Caliphate - 632

& Umayyad Caliphate-662

& Abbasid Caliphate -750

Prototype  
1

Prototype  
2

Prototype  
3

## 2-Fatimid - 969

Prototype  
1

Prototype  
2

## 3-Ayoubi - 1171

Prototype  
1

## 4-Mamluk - 1250

## 5-ottoman - 1517

## 6-Mohamed Ali - 1805

Prototype  
1

Prototype  
2

Prototype  
3

Prototype  
4

Prototype  
1

Prototype  
2

Prototype  
3

Prototype  
1

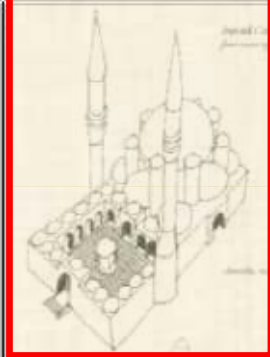
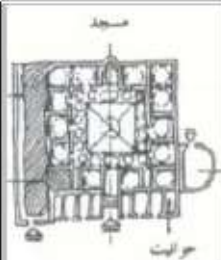
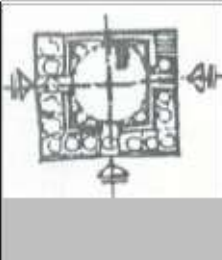
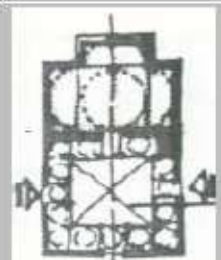
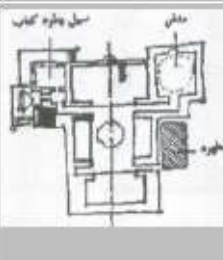
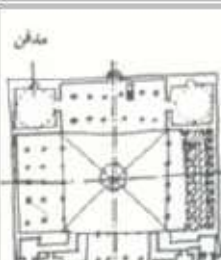
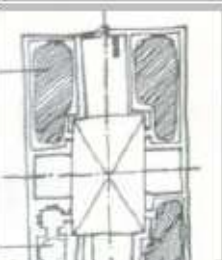
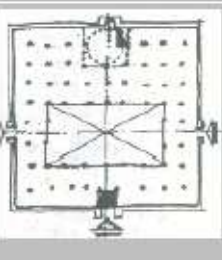
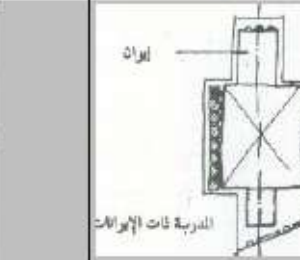
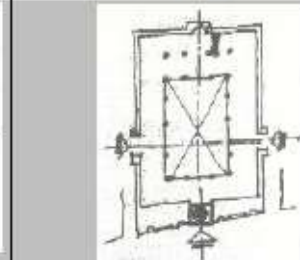
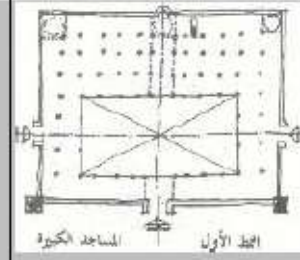
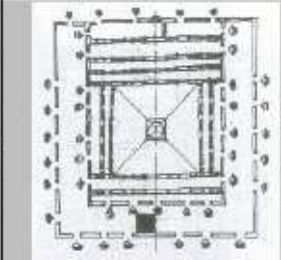
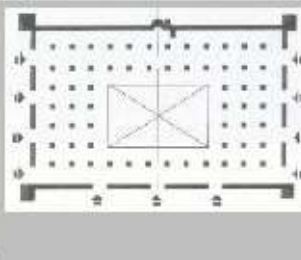
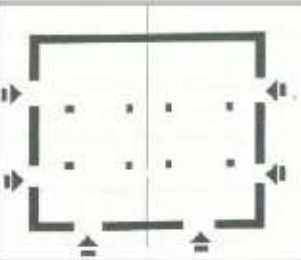

6-Mohamed Ali period- 1805

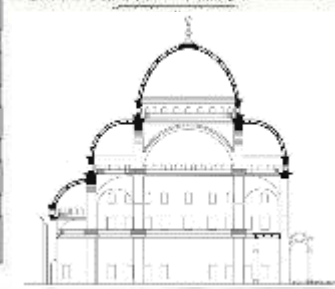
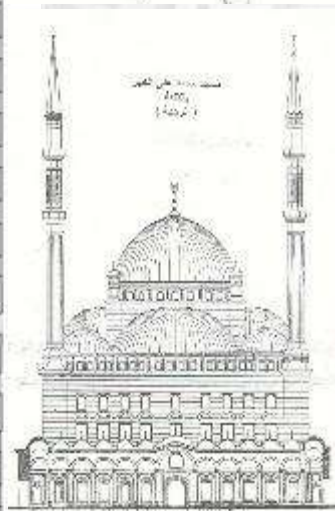
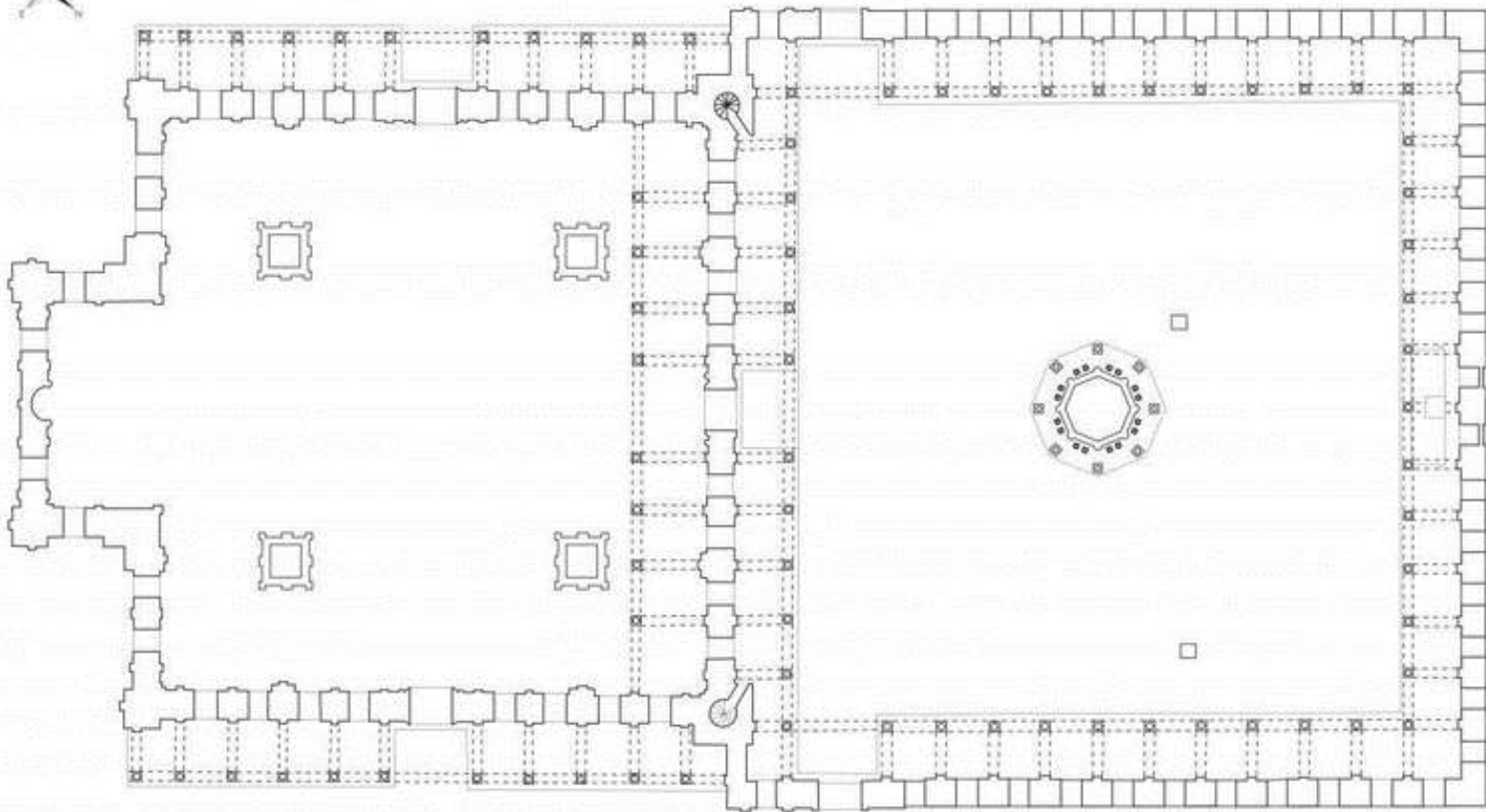
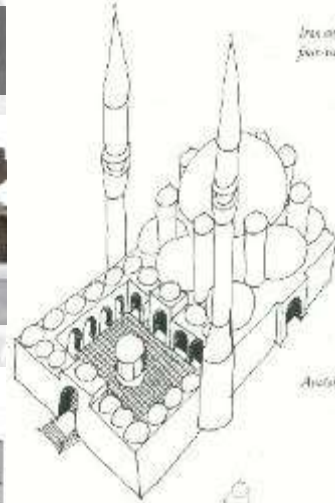
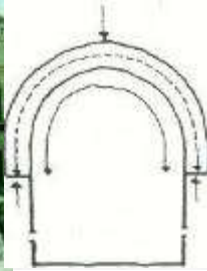

## BYZANTINE

ROMAN



The Minerva Medica, Rome, c. A.D. 260.

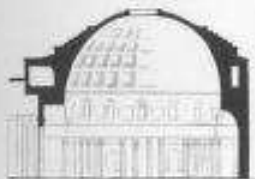

The Pantheon, Rome, A.D. 120-124

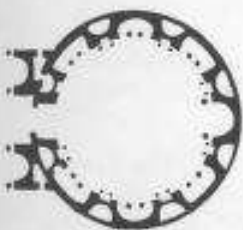

S. George, Salonika, c. A.D. 400.

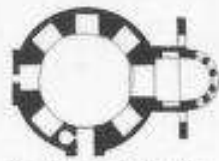

S. Vitale, Ravenna, A.D. 526-547

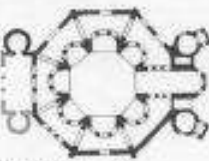

SS. Sergius and Bacchus, Constantinople, A.D. 527-553



Carolingian cathedral, Aix-la-Chapelle, A.D. 796-804

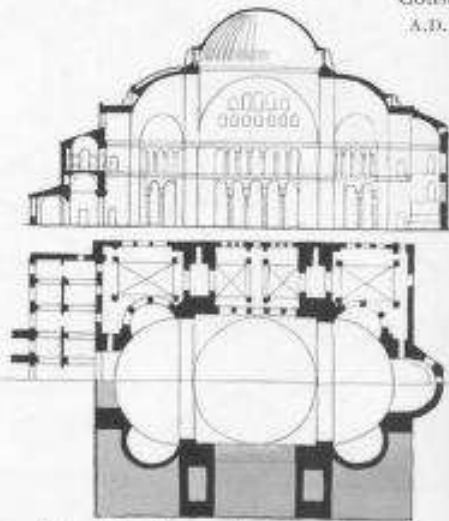

S. Sophia, Constantinople, A.D. 532-537

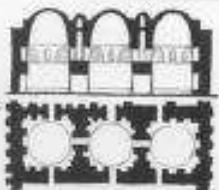

PERSIA: detail of Palace, Feruz-abad, A.D. 450

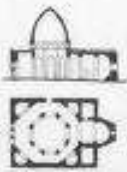

SYRIA: S. George, Ezra, c. A.D. 510

## COMPARATIVE PLANS

plans and sections in black to the same scale 150

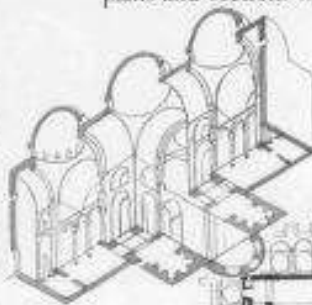

Holy Apostles, Salonika, A.D. 1200



S. Mark, Venice, A.D. 1042-1085

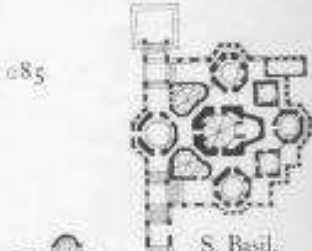
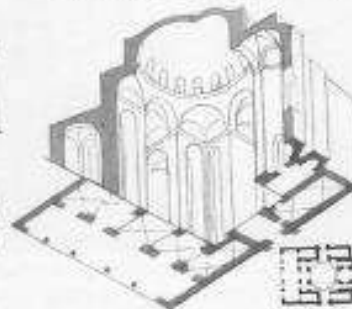

S. Basil, Moscow, A.D. 1554-1560

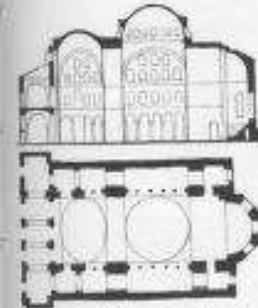

S. Irene, Constantinople, A.D. 740

Church, Daphni, nr Athens, c. 11th century A.D.

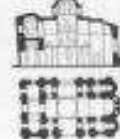

S. Saviour Pantepoptes, Constantinople, early 12th century



S. Sophia, Salonika, 6th century A.D.



S. Front, Perigueux, France, A.D. 1120

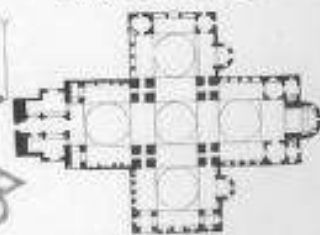

## BYZANTINE

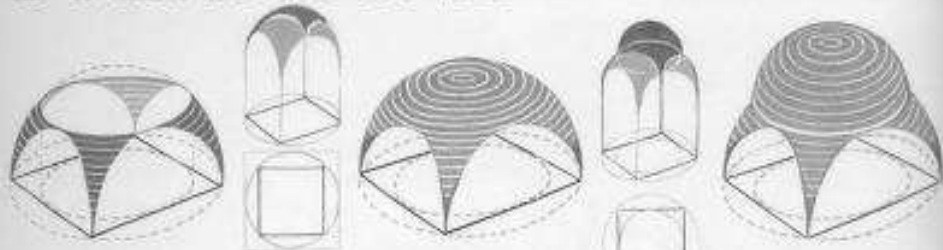

Pendentives

Dome and pendentives parts of one hemisphere

The dome a hemisphere set above pendentives



To build an arch centering is necessary,



but a dome can be built in successive rings of horizontal arches without centering

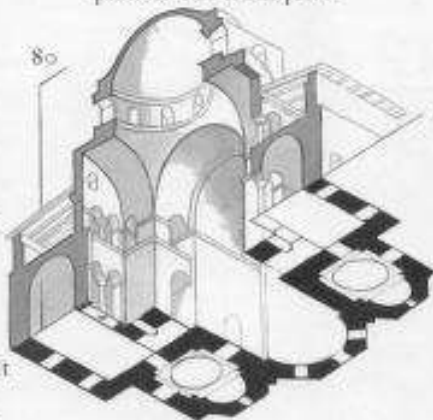

S. Sophia, Salonika, c.A.D. 495

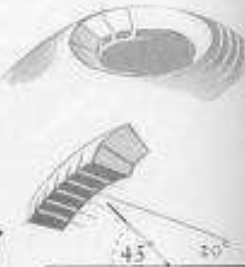

Domes on pendentives built with bricks not radiating from centre



Little Cathedral, Athens, A.D. 1250

Metropole Athens, A.D. 1250

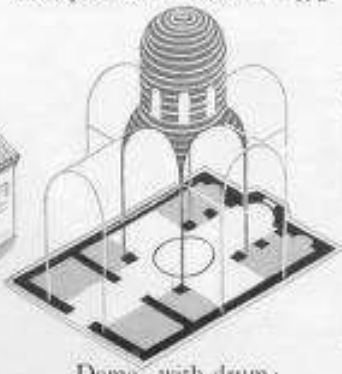

Dome with drum: cross-in-square plan

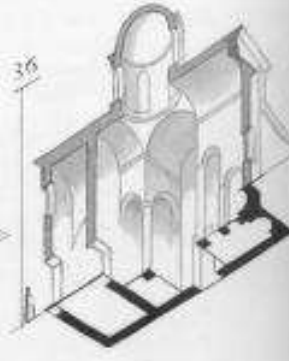

## DOMES ON PENDENTIVES

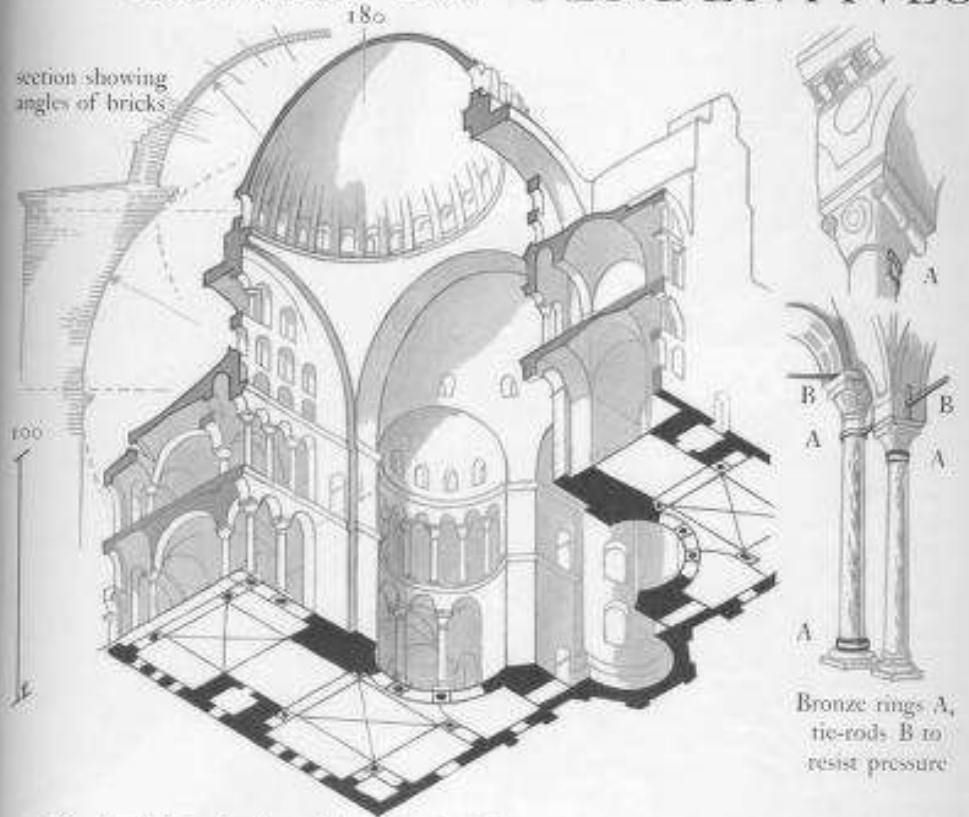

section showing angles of bricks

Bronze rings A, tie-rods B to resist pressure

S. Sophia (Hagia Sophia = divine wisdom), Constantinople, A.D. 532-537 (plan p.74)

Built for Justinian by two Greek architects, Anthemius of Tralles and Isidorus of Miletus. Built of brick; the dome probably erected without centering, with bricks about 14-27 inches square and 2 inches thick laid in deep mortar and covered with  $\frac{1}{4}$  inch lead; the dome supported on 4 piers, the thrust being taken by 2 semi-domes and 4 massive buttresses; the interior lined throughout in coloured marbles and mosaics.

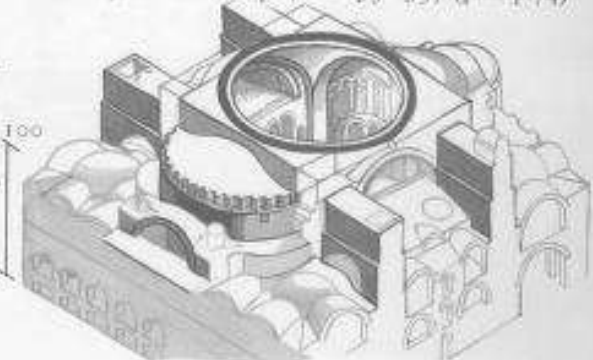

6-Mohamed Ali period- 1805

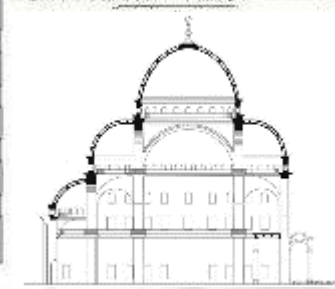
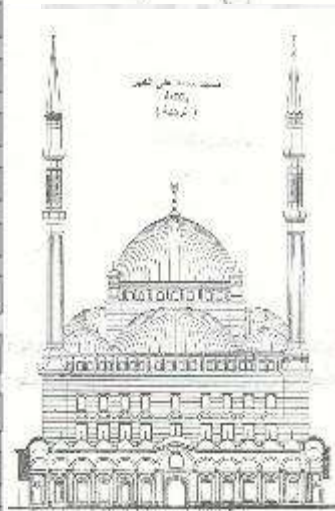
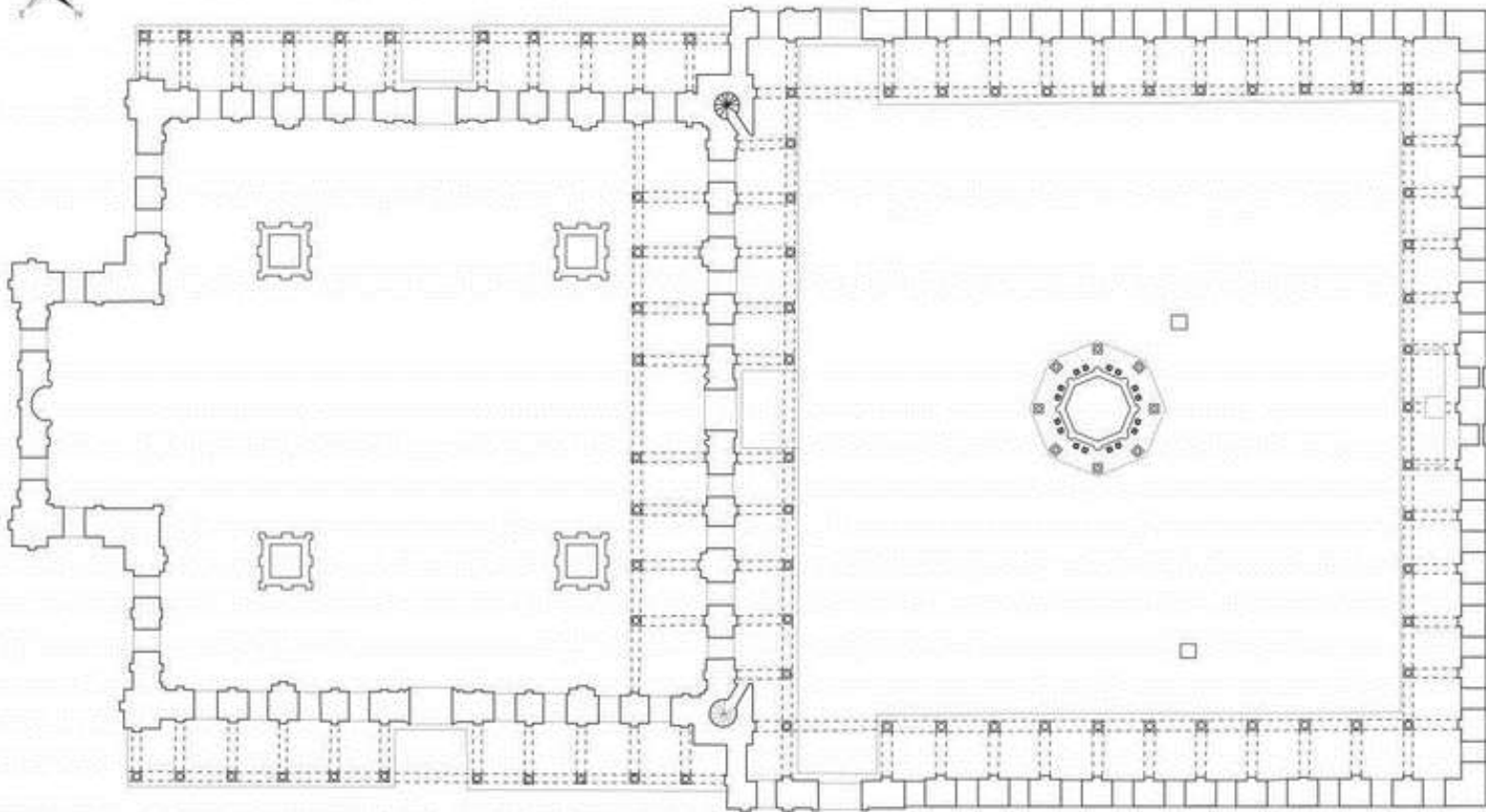
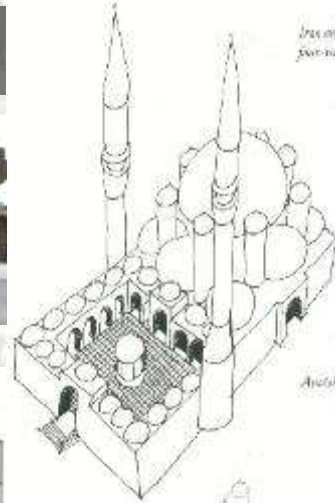
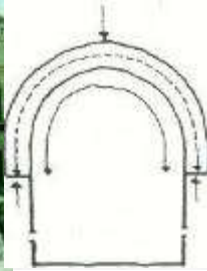



# HISTORY OF ISLAMIC ARCHITECTURE IN EGYPT

THANK YOU

FORM ARCHITECTURAL OF  
MOSQUES IN THE ISLAMIC  
ARCHITECTURE

DR/ KAMAL MAHMOUD  
ELGABALAWY

KAMAL\_ELGABALAWY@YAHOO.COM

**THE REFERENCES TO MULTIPLE SOURCES ARE TEXT & FIGURES  
(SKETCHES, DRAWINGS, PICTURES, PHOTOS,...ETC.)**

**ALL THE RIGHTS BELONG TO ORIGINAL AUTHORS**